

# Clearaudio Concept

**User manual** (adapted)

*Brian Rodson*<sup>TM</sup>



Thank you for purchasing the **Clearaudio Concept** turntable.

The **Clearaudio Concept** was handmade in Germany. It is equipped with the innovative **Concept** tonearm. The high-quality **Performer V2** moving magnet cartridge completes the package.

All parameters have been pre-adjusted, including the tracking and bias (anti-skating) force.

Please read the safety, setup and how to care for your concept turntable. Follow the instructions carefully to avoid any damage.

**Please note:**

This turntable has been refurbished, pre-setup and tested. The turntable includes non-original parts, however, this will not affect the functioning of the turntable. The turntable has been setup and tested to conform as closely as possible to the original factory setup and recommended settings for best listening. If you have a problem with the functioning of the turntable once you have unpacked and setup the turntable, please contact Brii Rodson.

This turntable has been pre-setup with correct settings for:

- Speed for 45, 33 $\frac{1}{3}$ , 78 and Xx (strobe tested)
- Tracking force (weight) 2.4g (suitable for the pre-installed Concept MM cartridge/stylus)
- Bias adjusted for the above tracking force



## **Safety instructions**

### **1. General information**

Check the turntable for any damage before using it. Do not connect the turntable if damaged!

Never connect the turntable if it has been dropped or gotten wet, contact your dealer to have the turntable checked.

Never expose the turntable to rain or moisture.

Never touch the power cord of the device with wet hands.

Regular visual inspections for defective insulation on the connection cable are also recommended for your own safety. A damaged cable should be replaced immediately by a specialist!

Never pull on the power cord to unplug the device. Always pull directly on the plug!

The inside of the turntable is maintenance free. Never open the case or attempt to repair the unit yourself, since this can lead to loss of warranty!

We recommend disconnecting the power supply from the mains if you do not operate the device for a longer period of time.

The turntable does not feature an automatic shut-off mechanism. Therefore, as soon as the stylus has reached the run-out groove, engage the tonearm lift and switch the turntable off.

Not suitable for children! Scope of delivery may contain small parts that can be swallowed.

### **2. Intended use**

The concept is a turntable for playing records.

The intended use of the concept in accordance with the information provided in the user manual only.

The power supply may only be operated with maximum permissible connection values according to the technical data.

Any other use or modification of this product is not intended.

**3. Location of installation** Avoid locations with direct sunlight, temperature fluctuations and high humidity.

Likewise, avoid placing electronic devices near heaters, heat lamps, or other devices that produce heat.

The device is designed for operation at room temperature.

No objects with an open flame may be placed on or near the device (burning candles or similar).

### **4. Overload**

The product is designed to comply with all necessary safety regulations. However, you should not leave the device unattended under extreme loads.

## 5. Maintenance

Never use aggressive cleaning detergent.

Do not use dry cloths for cleaning as this generates static electricity. Suitable cleaning and care products are available from specialist retailers.

The bearing of the turntable platter can be lubricated every 2 years with suitable oil.  
Put 1 or 2 drops of oil into the bearing for lubrication.

## 6. Health information

Permanently high volume can lead to various types of hearing damage. Use high volume responsibly!

## 7. Service

This product should only be serviced by a suitable turntable specialist/engineer.

## 8. Transport

Use the packing material provided for further transportation of the concept turntable, otherwise serious damage could occur. Be sure to pack the device exactly as it was shipped in the Brie Rodson supplied packaging.

Proceed in reverse to when unpacking.

Always remove the turntable platter and replace the tape securing the sub-platter as well as the foam securing the tonearm and the cartridge stylus protection. Otherwise, serious damage can occur.

Please also ensure that you fully retract the turntable feet.

For any transportation of the concept turntable, please ensure that the platter is packed with the upper surface facing downwards into the packaging.

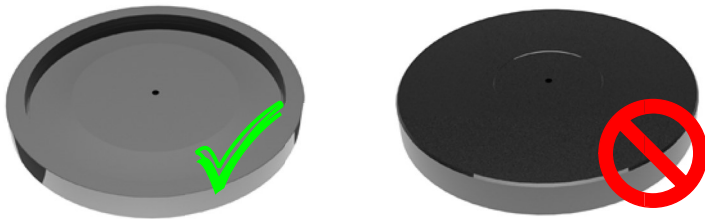

## 9. Disposal



Do not dispose this product together with other waste. WEEE Reg. No.: DE26004446

## 10. CE Marking



This electronic product corresponds to the applicable guidelines for obtaining the CE/CA mark.

The **Clearaudio** concept turntable is shipped in customized packing to ensure its safe transport. Please retain the packaging for any future transportation and shipping.

Please see the list below to check the contents of your **Clearaudio** concept turntable.

**First layer:**

Concept turntable chassis including integrated motor unit, sub platter and tonearm with cartridge.



**Second layer:**

Turntable platter and tonearm protector card



**Third Layer:**

Accessories – drive belt, Allen keys and DC power supply.



**Pic 1:** Packaging overview

## 2. List of components (what's in the box?)

- 1) Turntable chassis with tonearm including cartridge and stylus protector
- 2) Drive belt
- 3) Turntable platter and sub-platter
- 4) Power supply
- 5) Brii Rodson handling gloves  
*Please note, gloves are supplied to avoid fingerprints. Please be careful to avoid components slipping from your grip.*
- 6) Instructions for use



### 3. Set-up

Setting up the concept turntable is straight-forward. The turntable chassis, tonearm and cartridge are already assembled and all key parameters have been pre-adjusted.

The concept turntable needs a set-up space of at least 17 x 14 inches.

#### 3.1

First take the concept turntable chassis out of the package and place it on a suitable surface. Then remove the drive belt from the plastic bag.

#### 3.2

Place the drive belt around the sub-platter and around the motor pulley.

#### 3.3

Take the platter out of the package and carefully place it with both hands onto the shaft.

Make sure that the hollowed side faces down towards the sub-platter.

#### 3.4

Carefully remove the securing foam from the tonearm. Remove the triangular piece of cardboard from the gap between the tonearm and the magnet, so that the arm is suspended.

*Note: Please try to avoid moving the weight on the end of the tonearm as this has been pre-adjusted.*



**Pic. 2:** Placing the turntable

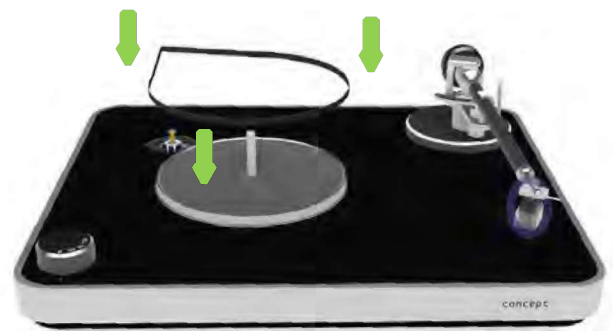

**Pic. 3:** Mounting the drive belt



**Pic. 4:** Placing the platter

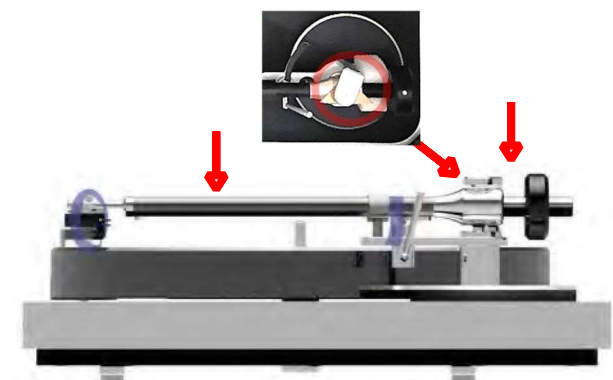

**Pic. 5:** Remove foam and cardboard piece

### 3.5

Please level the turntable using a suitable level gauge.

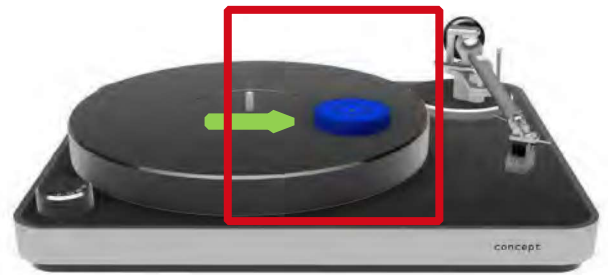

**Pic. 6:** Levelling the turntable

### 3.6

If the turntable is not level, please turn the turntable's feet clockwise or anti-clockwise until you reach the perfectly levelled position.

You will only get the best sound from your concept turntable if the turntable is perfectly levelled.

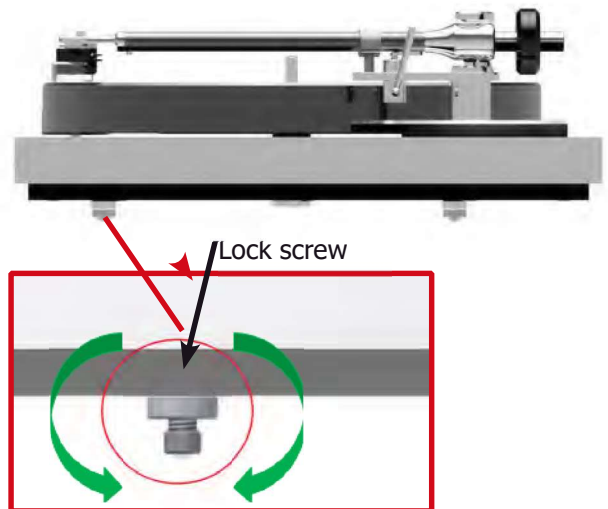

**Pic. 7:** Adjustment of the turntable feet

### 3.7

Connect one end of the external power supply provided to the socket on the rear of the concept turntable and the other end to a live AC outlet. Then connect the tonearm cable to your phono stage (red plug = right channel, black plug = left channel).

Your concept turntable is now completely assembled and ready to play.



**Pic. 8:** Power supply of the turntable

## 4. Important notes

### 4.1 Adjustment of the tracking force

Never check or adjust the tracking force when there is a record on the platter. Always remove the record first. The pre-adjusted and recommended tracking force for the **Clearaudio** concept MM cartridge is 2.2g ( $\pm 0.3$ g)

### 4.2 Adjustment of the tonearm height

Since everything on the turntable is pre-assembled and tested, including tonearm and cartridge, there is usually no need to change any parameters on the concept turntable. If you wish to change the height of your tonearm, please refer to your nearest qualified dealer or service personnel.

Your dealer can make the height adjustment by loosening the locking screw on the side of the tonearm base of your turntable.



**Pic. 9:** Adjustment of the tonearm height

### 4.3 Adjustment of the anti-skating force

As everything on the turntable is preassembled and tested, including tonearm and cartridge, there is usually no need to change any of the concept turntable parameters.

If you wish to change your cartridge and to adjust the anti-skating force, please refer to a qualified turntable service/repair specialist.

Your dealer will find the non-original anti-skating adjuster on the underside of the turntable.

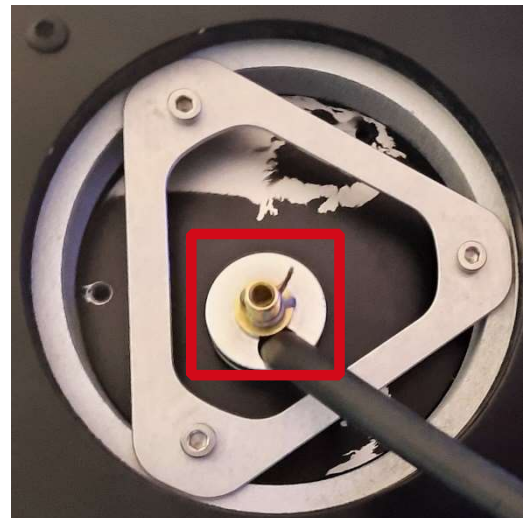

**Pic. 10:** Adjustment of the anti-skating

**Brii Rodson** assumes no liability for incorrect handling, or any damage caused if non-qualified persons attempt the above adjustments.

### 4.4 Fine speed adjustment

There is no need to check the speed before using the turntable for the first time as the motor adjustment is already pre-set.

We recommend using a stroboscope test record and with speed strobe light to adjust the speed as perfectly and precisely as possible.

On the rear side of your turntable (close to the power supply input) there are three speed setting controls:

- Left control = setting 78rpm
- Middle control = setting 45rpm
- Right control = setting 33 1/3rpm  
(near the power supply jack)



Pic. 11: Speed setting controls on the rear

### **Non-Original parts:**

- Tonearm suspension, dual tethering thread wire, replaced with a custom single thread wire.
- Tethering fixing/bias replaced with a custom modification.

## 5. Troubleshooting

If you have a problem with your concept turntable, first check the possible causes below to rule out incorrect operation. If the error persists, please contact Brii Rodson or a qualified turntable service/repair specialist!

**This is not a user serviceable turntable. Never try to open the device and/or repair it yourself! Please refer to the seller or a qualified turntable service/repair specialist.**

Error	Cause	Measure
<b>Device does not work</b>	Is the power cord plugged in?	Check the connection.
<b>No sound</b>	The tonearm and phono stage are not properly connected.	Check the cable connection between the tonearm and the phono stage.
	Is the amp turned on?	Check the power supply to the amplifier.
	The volume on the amplifier/ loudspeaker is set too low or on „mute“.	Check the volume settings.
	Is the cartridge protective cap still attached?	Remove the cartridge's protective cap.
	Is the tonearm in the raised position?	Lower the tonearm into the lead-in groove.
	Is the stylus damaged?	Check the stylus and have the cartridge checked by a specialist if necessary.
<b>Bad sound / noise</b>	Is the record or the stylus dirty or damaged?	Clean the record / or the cartridge. In the event of damage, we recommend an assessment by a specialist and, if necessary, a part replacement.
	Is the cartridge properly mounted into the tonearm?	Check the installation using the relevant user manual and correct them if necessary.
	Has the tracking force been set too high?	Adjust the tracking force.
	Is the correct operating mode (MM / MC) set on the amplifier?	Check the settings of your phono stage or phono amplifier.
	The pre/amp does not have enough gain.	Check the settings of your phono stage or phono amplifier.
	Pre/amp is mismatched.	Swap the plugs of the turntable that are connected to the left and right outputs.

<b>Needle bounces or slides across record</b>	Is the record or the stylus dirty or damaged?	Clean the record / or the cartridge. We recommend an assessment by a specialist and, if necessary, a part replacement.
	Has the tracking force been set too high?	Adjust the tracking force.
	Is the record deformed or scratched?	Use a record clamp or replace the record.
	Is the turntable level?	Check the alignment of the turntable and adjust if necessary.
<b>Platter does not turn</b>	Is the drive belt properly attached?	Check the position of the drive belt.
	Is the power cord connected properly?	Check the connection.
	No speed was selected / speed selection in position „0“/“OFF“.	Select a speed and start the turntable.
<b>Noisy sound</b>	Is the drive belt properly attached?	Check the position of the drive belt. Is it too loose and needs to be changed?
<b>Humming noises</b>	Contact problems with the signal connections (e.g. cinch plugs, adapters for extensions)	Check all connections; reduce the level on the (pre-)amplifier to a low volume for acoustic checking of gross errors.
	Metal housing acts as an antenna and catches hum.	It can be helpful for conductivity to connect the metal parts of the turntable to the ground of the (phono) preamplifier. The turntable provides a grounding terminal for this purpose. Use a sufficiently thick wire to establish the ground connection.
	The pickup pins are mixed up, not connected correctly or defective.	Check the pin assignment of the pickup.
<b>The music doesn't sound like usual</b>	Wrong speed selected.	Check the record for recommended speed.  There are also records in LP format (30 cm) that have to be played at 45 rpm ("maxi singles") and small records in single format (17 cm) that have to be played at 33 rpm (so-called "EP's").
	The turntable is spinning too fast/too slow.	Adjust the speed according to the operating instructions.

## 6. Technical data



### Clear Audio Concept Turntable

Retail price (new): £1400 approx.

Resonance-optimised turntable; chassis comprises medium-density wood fibre (silver / black) ; upper layer incorporates high-tech satined plastic compound.

<b>Construction details:</b>	Resonance-optimised turntable; chassis comprises medium-density wood fibre (silver / black); upper layer incorporates high-tech satined plastic compound.
<b>Speed options:</b>	33 1/3, 45, 78rpm
<b>Drive unit:</b>	Decoupled and resonance damped 12V DC motor, flat belt-drive and plug-in power supply unit, designed for worldwide use with all networks and power frequencies.
<b>Bearing:</b>	Polished and tempered steel spindle in a sintered bronze housing, running on a teflon thrust pad.
<b>Platter:</b>	30mm / 1.18 inch main platter, made out of synthetic material with high-density and excellent dimension / precision CNC machined aluminium sub-platter.
<b>Speed accuracy (measured):</b>	± 0.05%
<b>Power consumption:</b>	Max. consumption: 2.5 watts // Consumption in operation: 0.5 watts // Off mode: 0.0 watts
<b>Total weight:</b>	Approx. 7.5kg (incl. tonearm and cartridge)
<b>Dimensions (W/D/H):</b>	Approx. 16.54 x 13.78 x 4.92 inches (with tonearm)
<b>Dimensions (W/D/H):</b>	Approx. 420 x 350 x 125mm (with tonearm)

## Tonearm: Concept

Retail price (new, separate): £370 approx.

Features friction-free magnetic bearing technology, which eliminates bearing chatter and offers superior stability. The Concept tonearm's magnetic bearing allows the Concept turntable to be shipped with cartridge pre-installed and calibrated for plug-and-play convenience. The low mass, rigid aluminium arm tube uses a two-piece aluminium headshell with adjustable azimuth for accurate alignment of the phono cartridge and easy replacement.

<b>Construction details:</b>	Radial tonearm, with friction free magnetic bearing technology.
<b>Material:</b>	Aluminium (silver), tonearm tube made of black aluminium.
<b>Cartridge balance range:</b>	2.5g - 17.0g
<b>Overhang:</b>	17.56mm
<b>Total length:</b>	305.00mm
<b>Effective length:</b>	239.56mm
<b>Mounting distance (tonearm pivot to spindle):</b>	222.00mm
<b>Offset angle:</b>	24.16°
<b>Wiring:</b>	1.1m Clearaudio Direct Wire PLUS terminated with RCA.
<b>Weight:</b>	450g (incl. counterweight)



## Cartridge: Clearaudio Performer V2, moving magnet

<b>Total mass:</b>	8.4g ( $\pm 0.4$ g)
<b>Frequency response:</b>	20Hz - 20kHz
<b>Output voltage:</b>	(1 kHz, 5 cm/s): $\sim 3.3$ mV
<b>Channel separation:</b>	(1kHz): 20dB
<b>Channel balance:</b>	(1kHz): 1.5dB
<b>Tracking ability:</b>	80 $\mu$ m
<b>Recommended tracking force:</b>	(1.8 – 2.6 g): 2.2 g $\pm$ 0.3 g
<b>Coil impedance</b>	(1kHz): 0.66k $\Omega$
<b>Coil inductance:</b>	400mH
<b>Load resistance:</b>	47k $\Omega$
<b>Load capacitance:</b>	100pF
<b>Cantilever:</b>	Aluminium
<b>Stylus shape:</b>	Elliptical
<b>Compliance:</b>	15 $\mu$ /mN
<b>Cartridge body:</b>	Ebony Wood